

# CT267

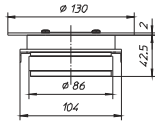
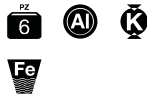

Compression tweeter  
Aluminum ring diaphragm  
Ferrofluid cooled

## GENERAL SPECIFICATIONS

Program power	300 W
Rated impedance	4 Ω
Nominal diameter	1" - 26 mm
Sensitivity (1W/1m)	105 dB
Voice coil diameter	26 mm
Frequency range	3 - 20 kHz

## TECHNICAL SPECIFICATIONS

Power handling capacity	150 W
Gap height	4 mm
N. of mounting holes	4 ∅ 5 / ∅ 116
Front mount baffle cutout ∅	95 mm
Re	3,20 Ω
Fs	1,80 kHz
Qms	-
Qes	-
Qts	-
Mms	-
Cms	-
D	-
Vas	-
B · l	-
Xmax	-
η <sub>0</sub>	-
Le	0,02 mH
Net weight	1,15 Kg
Recomm. crossover freq.	5 kHz
Volume / Tuning frequency	-

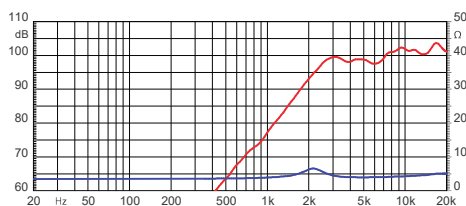

# CT268ND

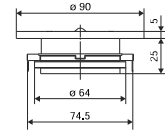

Compression tweeter  
Aluminum ring diaphragm  
Ferrofluid cooled  
Neodymium magnet

## GENERAL SPECIFICATIONS

Program power	250 W
Rated impedance	4 Ω
Nominal diameter	1" - 26 mm
Sensitivity (1W/1m)	105 dB
Voice coil diameter	26 mm
Frequency range	4 - 20 kHz

## TECHNICAL SPECIFICATIONS

Power handling capacity	150 W
Gap height	-
N. of mounting holes	4 ∅ 5,5 / ∅ 116
Front mount baffle cutout ∅	64 mm
Re	3,25 Ω
Fs	2,30 kHz
Qms	-
Qes	-
Qts	-
Mms	-
Cms	-
D	-
Vas	-
B · l	-
Xmax	-
η <sub>0</sub>	-
Le	-
Net weight	0,45 Kg
Recomm. crossover freq.	5 kHz
Volume / Tuning frequency	-

